

2018 PACBIO  
USER GROUP MEETINGS  
**NORTH AMERICA**  
**SEPTEMBER 19-20**

THE LEADER IN LONG-READ SEQUENCING



PacBio North America User Group Meeting  
September 19 – 20, 2018  
Eric P. Newman Education Center, Washington University School of Medicine in St. Louis

## Event Logistics & Details for Attendees

Location: Washington University School of Medicine in St. Louis  
[Eric P. Newman Education Center \(EPNEC\)](#)  
320 S Euclid Ave, St. Louis, MO 63110  
**FOR GPS: 224 South Euclid, St. Louis, MO 63110**  
314.747.6338

Day 1: Wednesday, September 19, 2018  
8:00 a.m. – 5:00 p.m. Offsite reception to follow (details below)

Day 2: Thursday, September 20, 2018  
8:00 a.m. – 3:00 p.m.

### PacBio Onsite Event Contact

Jenny Alfrey, Field Marketing Manager  
Cell: 859.303.1386  
Email: [jalfrey@pacb.com](mailto:jalfrey@pacb.com)

### UGM Meeting Details

- Meeting [agenda can be found here](#)
- Registration will be in the EPNEC Atrium Lobby
- All meals will be in Great Room A and B
- All General Session talks will be in the Auditorium
- Breakout Sessions:
  - Will be in the Auditorium, Seminar A, and Seminar B
  - Breakout Groups will be assigned on name badges Day 1
  - Meet in your assigned room for all three breakout sessions

## EPNEC 1<sup>ST</sup> FLOOR

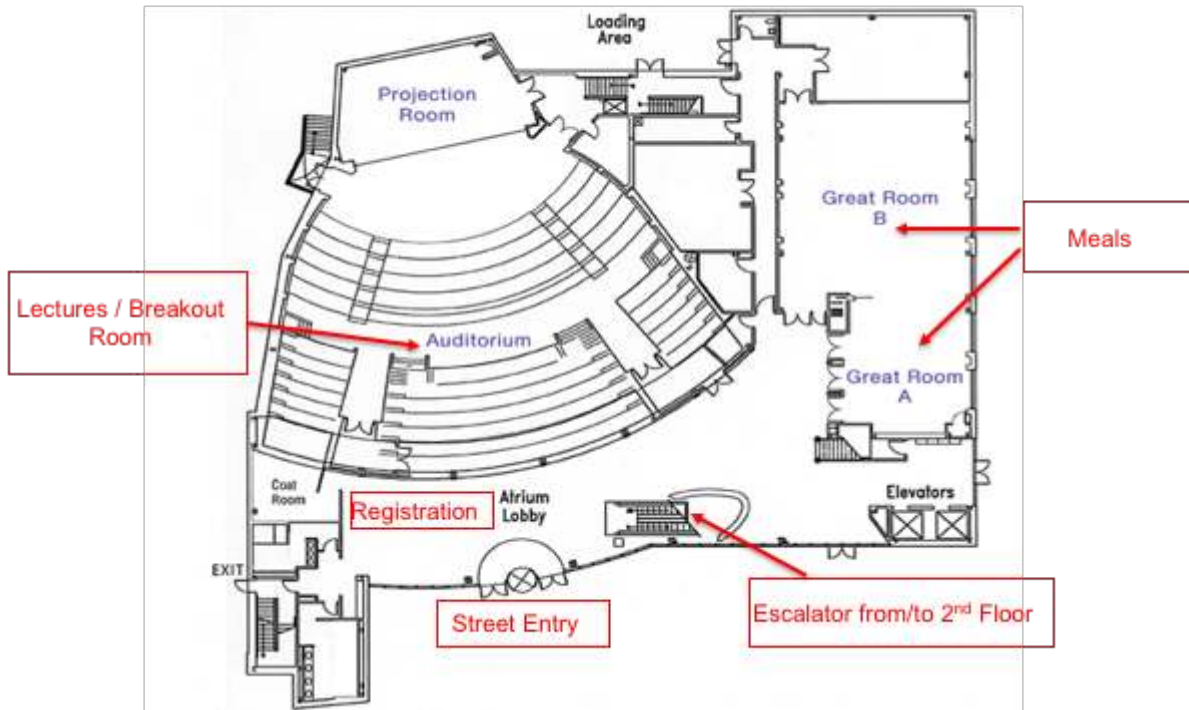

## EPNEC 2<sup>ND</sup> FLOOR

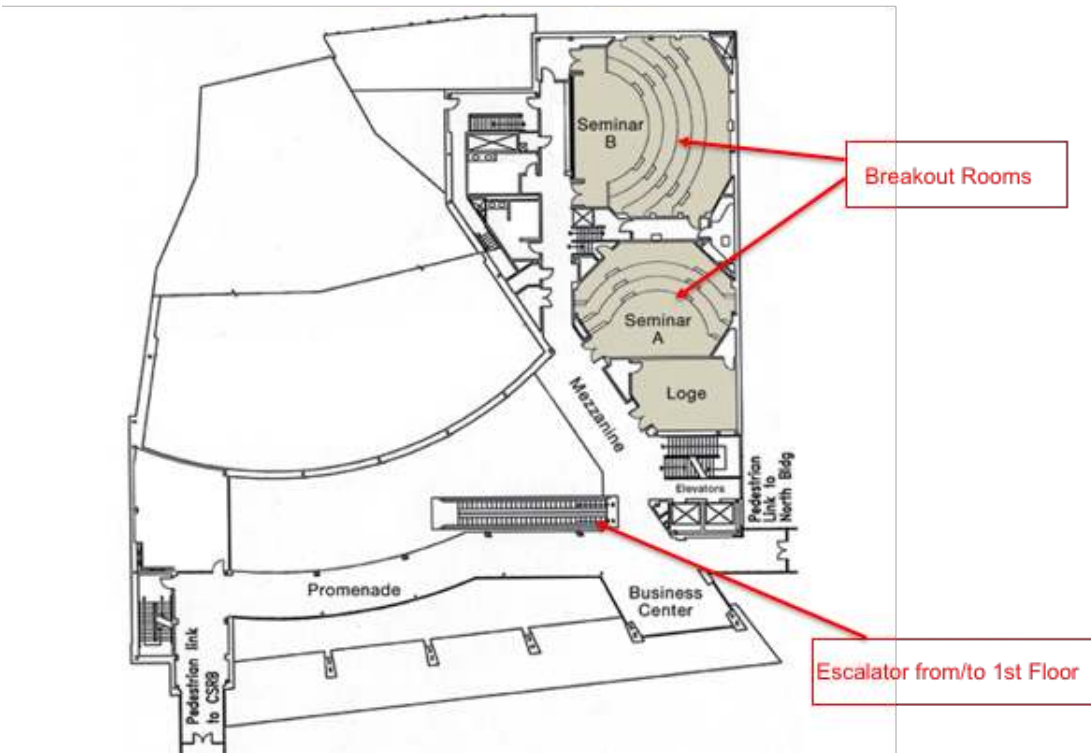

### UGM Parking Information

- If you are staying at the [Parkway Hotel](#), please park with the hotel; the EPNEC is connected by covered walkway on the 3<sup>rd</sup> floor of the Parkway. Once you are in the EPNEC, you will be on the 2<sup>nd</sup> floor; please proceed down the stairs to locate the Atrium Lobby.
- If you are not staying at the Parkway Hotel, please use levels 6 and 7 of the **Metro Garage** (\$15 per day, cash or credit) at 4560 Children's Place, St. Louis, MO 63110. Detailed parking instructions are also below (page 4). To walk indoors, enter the pedestrian walkway at the 3<sup>rd</sup> level of the garage, turn left, and then make the first right. Walk a short distance, and you will enter EPNEC at the 2<sup>nd</sup> level.

### Wi-Fi Information

Wi-Fi will be available onsite; login details provided at EPNEC.

### Offsite Reception

Please join us for an offsite reception at the end of Day 1, Wednesday, September 19.

Location: The City Museum 750 N 16th St, St. Louis, MO 63103

Date/Time: Wednesday, September 19, 2018 / 6:00 p.m. – 9:00 p.m.

Attire: Casual. Closed-toed shoes (preferably sneakers) and no sandals/flip flops to interact in the museum.

Food: Bar, soft drinks, light appetizers

Transportation: Buses will start loading from The EPNEC lobby at 5:30 p.m.

Parking: If driving, use the main Serpent Parking Lot at 16<sup>th</sup> Street and Delmar (\$0) or the Overflow Parking Lot (\$0). Parking is limited and is first-come, first-serve.

We look forward to seeing you September 19<sup>th</sup>!

Log onto <https://meet.wustl.edu/spaces/locations/> for current map and driving directions to garages.

## Campus Construction Information:

[Click here to view the latest road closures.](#)

## Parking:

Upon arriving, please utilize levels 6-7 of the Metro Parking Garage located at the corner of Taylor Avenue and Children's Place. The garage address is 4560 Children's Place, St. Louis, MO 63110. To walk indoors, enter the pedestrian walkway at the 3<sup>rd</sup> level of the garage turn left, and then make the first right. Walk a short distance, and you will enter EPNEC at the 2<sup>nd</sup> level.

## Payment:

Please note that the Metro Parking Garage accepts cash or credit. Daily rate is \$15.00. Keep your parking ticket with you so that you can access the garage.

### From Forest Park Avenue\*:

- South on Taylor Avenue
- Right on Children's Place
- Left into Metro Garage
- Exit garage to the left and walk a short block to EPNEC — it will be on the right side.

### From the airport:

- I-70 east to I-170 south
- I-170 south to 64/40
- East on 64/40 to Kingshighway
- North on Kingshighway to Forest Park Ave
- Turn Right on Forest Park Ave to Taylor Ave
- Turn Right on Taylor Ave to Children's Place
- Turn Right on Children's Place
- Turn Left into Metro garage
- Exit garage to the left and walk a short block to EPNEC— it will be on the right side.

### From downtown St. Louis and points east:

- West on I-55, I-70, I-64
- Take Forest Park Avenue / Grand Boulevard exit
- Forest Park Avenue west to Taylor Avenue
- Left on Taylor Avenue to Children's Place
- Right on Children's Place
- Left into Metro Garage
- Exit garage to the left and walk a short block to EPNEC— it will be on the right side.

### Via MetroLink:

- Detrain at the Central West End stop.
- Ascend stairs or use elevator to Euclid Avenue
- Right on Euclid Avenue to EPNEC

